

ACTIONS ATTACHEMENT

PRIX PROMOTIONNELS NET HT
OFFRE VALABLE JUSQU'AU 31-12-2018



DOUILLES DE REDUCTION CYLINDRIQUES

| D | L | Ø D | Code |
|----|----|-----|---------|
| | | 6 | 427570B |
| | | 8 | 427571B |
| | | 10 | 427572B |
| 32 | 90 | 12 | 427573B |
| | | 16 | 427574B |
| | | 20 | 427575B |
| | | 25 | 427576B |

30,00
€ HT

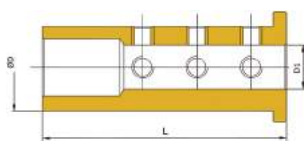

| D | L | Ø D | Code |
|----|-----|-----|---------|
| | | 8 | 427930B |
| | | 10 | 427931B |
| | | 12 | 427932B |
| 40 | 110 | 16 | 427933B |
| | | 20 | 427934B |
| | | 25 | 427935B |
| | | 32 | 427936B |

30,00
€ HT



RALLONGE PORTE PINCES | ER - ECROU MINI



| TYPE | CAP | D | D1 | L | Code | Prix € net HT |
|------|--------|----|----|-----|--------|---------------|
| ER8 | 1 - 5 | 12 | 12 | 100 | 870001 | 30,00 |
| ER11 | 1 - 7 | 16 | 8 | 55 | 870002 | 28,00 |
| ER11 | 1 - 7 | 16 | 10 | 60 | 870003 | 30,00 |
| ER11 | 1 - 7 | 16 | 12 | 70 | 870004 | 30,00 |
| ER11 | 1 - 7 | 16 | 16 | 100 | 870005 | 32,00 |
| ER16 | 1 - 10 | 22 | 10 | 60 | 870006 | 30,00 |
| ER16 | 1 - 10 | 22 | 12 | 80 | 870007 | 30,00 |
| ER16 | 1 - 10 | 22 | 26 | 80 | 870008 | 32,00 |
| ER16 | 1 - 10 | 22 | 16 | 130 | 870009 | 33,00 |
| ER16 | 1 - 10 | 22 | 20 | 100 | 870010 | 32,00 |
| ER16 | 1 - 10 | 22 | 20 | 160 | 870011 | 38,00 |
| ER16 | 1 - 10 | 22 | 25 | 100 | 870012 | 36,00 |
| ER16 | 1 - 10 | 22 | 25 | 160 | 870013 | 46,00 |
| ER16 | 1 - 10 | 22 | 32 | 90 | 870014 | 56,00 |
| ER20 | 1 - 13 | 28 | 16 | 100 | 870015 | 33,00 |
| ER20 | 1 - 13 | 28 | 20 | 100 | 870016 | 46,00 |
| ER20 | 1 - 13 | 28 | 20 | 160 | 870017 | 46,00 |
| ER20 | 1 - 13 | 28 | 25 | 100 | 870018 | 36,00 |
| ER20 | 1 - 13 | 28 | 25 | 160 | 870019 | 46,00 |
| ER20 | 1 - 13 | 28 | 32 | 95 | 870020 | 56,00 |
| ER25 | 1 - 16 | 35 | 20 | 100 | 870021 | 46,00 |
| ER25 | 1 - 16 | 35 | 25 | 70 | 870022 | 34,00 |
| ER25 | 1 - 16 | 35 | 25 | 130 | 870023 | 62,50 |



POUR 2 PIÈCES ACHETÉES = REMISE DE 10%

PINCES ETANCHES AVEC JOINT | ERXG 32 - DIN 6499

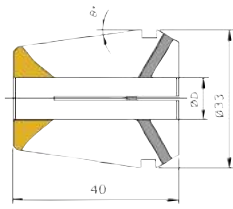

| Ø D | Code | Ø D | Code | Ø D | Code |
|-----|---------|-----|---------|-----|---------|
| 4 | 427300B | 10 | 427306B | 16 | 427312B |
| 5 | 427301B | 11 | 427307B | 17 | 427313B |
| 6 | 427302B | 12 | 427308B | 18 | 427314B |
| 7 | 427303B | 13 | 427309B | 19 | 427315B |
| 8 | 427304B | 14 | 427310B | 20 | 427316B |
| 9 | 427305B | 15 | 427311B | | |



PINCES POUR TARAUD | ERXM 32 - DIN 6499

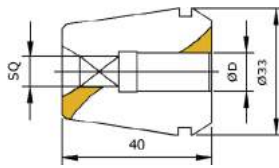

| Ø D | Code | Ø D | Code |
|-----|------------|-----|-------------|
| 4,5 | 3,4 423760 | 9 | 7,0 423766 |
| 5 | 4,0 423761 | 10 | 8,0 423767 |
| 5,5 | 4,3 423762 | 11 | 9,0 423768 |
| 6 | 4,9 423763 | 12 | 9,0 423769 |
| 7 | 5,5 423764 | 14 | 11,0 423770 |
| 8 | 6,2 423765 | 16 | 12,0 423774 |



SERIE PINCES ER16 | ER32 | ER32UP



| SERIE PINCES | Code | Prix € net HT |
|--|---------|---------------|
| SERIE 8 PINCES ER16 DIN6499 CLASSE 1 Ø D 3-10 | 427996P | 67,00 |
| SERIE 18 PINCES ER32 DIN6499 CLASSE 1 Ø D 3-20 | 427999P | 115,00 |
| SERIE 18 PINCES ER32UP DIN6499 CLASSE 1 Ø D 3-20 | 427903P | 207,00 |



PINCES ER16

PINCES ER16 CLASSE 1



| Ø D | Code |
|--------|---------|
| 3 - 2 | 427334B |
| 4 - 3 | 427335B |
| 5 - 4 | 427336B |
| 6 - 5 | 427337B |
| 7 - 6 | 427338B |
| 8 - 7 | 427339B |
| 9 - 8 | 427340B |
| 10 - 9 | 427341B |

PINCES ER16 DE PRECISION 5 MICRONS



| Ø D | Code | Ø D | Code | Ø D | Code |
|-----------|--------|-----------|--------|-----------|--------|
| 3 - 2 | 423244 | 5,5 - 4,5 | 423249 | 8 - 7 | 423254 |
| 3,5 - 2,5 | 423245 | 6 - 5 | 423250 | 8,5 - 7,5 | 423255 |
| 4 - 3 | 423246 | 6,5 - 5,5 | 423251 | 9 - 8 | 423256 |
| 4,5 - 3,5 | 423247 | 7 - 6 | 423252 | 9,5 - 8,5 | 423257 |
| 5 - 4 | 423248 | 6,5 - 7,5 | 423253 | 10 - 9 | 423258 |

PINCES ER32

PINCES ER32 CLASSE 1



| Ø D | Code | Ø D | Code | Ø D | Code |
|---------|---------|---------|---------|---------|---------|
| 2 - 1,5 | 427248B | 9 - 8 | 427256B | 16 - 15 | 427263B |
| 3 - 2 | 427250B | 10 - 9 | 427257B | 17 - 16 | 427264B |
| 4 - 3 | 427251B | 11 - 10 | 427258B | 18 - 17 | 427265B |
| 5 - 4 | 427252B | 12 - 11 | 427259B | 19 - 18 | 427266B |
| 6 - 5 | 427253B | 13 - 12 | 427260B | 20 - 19 | 427267B |
| 7 - 6 | 427254B | 14 - 13 | 427261B | | |
| 8 - 7 | 427255B | 15 - 14 | 427262B | | |

PINCES ER32 DE PRECISION 5 MICRONS



| Ø D | Code | Ø D | Code | Ø D | Code |
|---------|--------|---------|--------|---------|--------|
| 2 - 1,5 | 427248 | 9 - 8 | 427256 | 16 - 15 | 427263 |
| 3 - 2 | 427250 | 10 - 9 | 427257 | 17 - 16 | 427264 |
| 4 - 3 | 427251 | 11 - 10 | 427258 | 18 - 17 | 427265 |
| 5 - 4 | 427252 | 12 - 11 | 427259 | 19 - 18 | 427266 |
| 6 - 5 | 427253 | 13 - 12 | 427260 | 20 - 19 | 427267 |
| 7 - 6 | 427254 | 14 - 13 | 427261 | | |
| 8 - 7 | 427255 | 15 - 14 | 427262 | | |

PINCES ETANCHE MECANIQUE | ER32



| Ø D | Code | Ø D | Code |
|-----|--------|-----|--------|
| 3 | 800003 | 12 | 800012 |
| 4 | 800004 | 13 | 800013 |
| 5 | 800005 | 14 | 800014 |
| 6 | 800006 | 15 | 800015 |
| 7 | 800007 | 16 | 800016 |
| 8 | 800008 | 17 | 800017 |
| 9 | 800009 | 18 | 800018 |
| 10 | 800010 | 19 | 800019 |
| 11 | 800011 | 20 | 800020 |

MANDRIN PORTE-FRAISE | A QUEUE FILETÉE

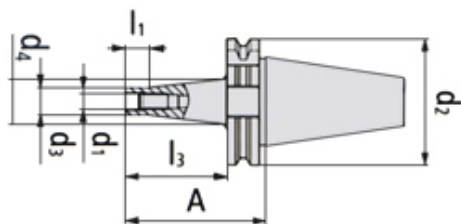

EQUILIBRE 20 000 TRS/MN G2,5

• GRANDE PRÉCISION $\leq 0,003$



| | D | D1 | D3 | D4 | L | L1 | Code | Prix € net HT |
|--------|-----|------|------|----|----|----|--------|---------------|
| DIN 40 | M8 | 8,5 | 13,8 | 15 | 25 | 10 | 087338 | 80,00 |
| | M10 | 10,5 | 18 | 23 | 25 | 10 | 087339 | 80,00 |
| | M12 | 12,5 | 21 | 24 | 25 | 10 | 087340 | 80,00 |
| | M16 | 17,0 | 29 | 29 | 25 | 10 | 087341 | 80,00 |
| BT 40 | M8 | 8,5 | 13,8 | 15 | 25 | 10 | 087364 | 80,00 |
| | M10 | 10,5 | 18 | 23 | 25 | 10 | 087367 | 80,00 |
| | M12 | 12,5 | 21 | 24 | 25 | 10 | 087370 | 80,00 |
| | M16 | 17,0 | 29 | 9 | 25 | 10 | 087373 | 80,00 |



LONGUEURS 50 - 70 - 100 EN STOCK | PRIX SUR DEMANDE

MANDRIN PORTE-FRAISE | TROU LISSE AVEC ARROSAGE

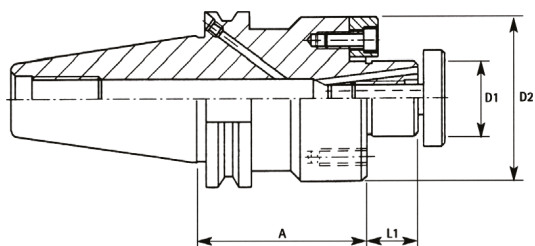

| | A | D1 | D2 | L1 | Code | Prix € net HT |
|--------|----|----|----|----|--------|---------------|
| DIN 40 | 45 | 16 | 38 | 17 | 840118 | 47,00 |
| | 45 | 22 | 48 | 19 | 840119 | 47,00 |
| | 50 | 27 | 58 | 21 | 840120 | 48,00 |
| | 55 | 32 | 66 | 24 | 840121 | 51,00 |
| | 55 | 40 | 80 | 27 | 840122 | 62,00 |
| BT 40 | 45 | 16 | 38 | 17 | 840417 | 47,00 |
| | 45 | 22 | 48 | 19 | 840418 | 47,00 |
| | 45 | 27 | 58 | 21 | 840419 | 48,00 |
| | 50 | 32 | 78 | 24 | 840420 | 55,00 |
| | 55 | 40 | 88 | 27 | 840421 | 62,00 |

EQUILIBRE 15 000 TRS/MN G6,3

• GRANDE PRÉCISION $\leq 0,003$

MANDRINS DE FRETTAGE



WKE

MEILLEUR RAPPORT QUALITÉ/PRIX



BT 40

| D | L | Code | Prix € promo HT |
|----|-----|--------|--------------------|
| 3 | 90 | 770036 | 106,92 |
| 6 | 90 | 770001 | 89,60 |
| 6 | 90 | 770005 | 82,31 |
| 6 | 160 | 770006 | 115,38 |
| 8 | 90 | 770007 | 82,31 |
| 10 | 90 | 770009 | 82,31 |
| 12 | 90 | 770011 | 82,31 |
| 12 | 120 | 770154 | 109,23 |
| 16 | 90 | 770015 | 82,31 |
| 16 | 120 | 770156 | 109,23 |
| 20 | 90 | 770019 | 82,31 |
| 20 | 120 | 770158 | 109,23 |
| 25 | 120 | 770159 | 109,23 |



DIN 40

| | | | |
|----|-----|--------|--------|
| 4 | 80 | 740023 | 99,23 |
| 5 | 80 | 740024 | 99,23 |
| 6 | 80 | 740006 | 78,46 |
| 6 | 80 | 740002 | 93,08 |
| 8 | 80 | 740003 | 93,08 |
| 6 | 200 | 740046 | 127,69 |
| 8 | 80 | 740008 | 78,46 |
| 10 | 80 | 740010 | 78,46 |
| 12 | 80 | 740012 | 78,46 |
| 12 | 160 | 740013 | 111,54 |
| 12 | 200 | 740049 | 127,69 |
| 16 | 80 | 740016 | 78,46 |
| 20 | 80 | 740020 | 78,46 |
| 20 | 160 | 740021 | 111,54 |
| 25 | 100 | 740025 | 80,77 |
| 25 | 130 | 740044 | 105,38 |
| 32 | 100 | 740026 | 86,15 |



HSK63A

| | | | |
|----|-----|--------|--------|
| 6 | 80 | 730017 | 93,08 |
| 6 | 120 | 730002 | 120,00 |
| 8 | 80 | 730003 | 109,23 |
| 8 | 160 | 730049 | 143,08 |
| 10 | 80 | 730005 | 109,23 |
| 10 | 85 | 730019 | 93,08 |
| 16 | 95 | 730010 | 93,08 |
| 10 | 120 | 730006 | 120,00 |
| 10 | 120 | 730086 | 150,77 |
| 10 | 160 | 730050 | 143,08 |
| 20 | 160 | 730055 | 143,08 |



BT 40

| D | L | Code | Prix € net HT |
|----|----|---------|------------------|
| 6 | 80 | 740006W | 61,00 |
| 8 | 80 | 740008W | 61,00 |
| 10 | 80 | 740010W | 61,00 |
| 12 | 80 | 740012W | 61,00 |
| 14 | 80 | 740014W | 61,00 |
| 16 | 80 | 740016W | 61,00 |
| 18 | 80 | 740018W | 61,00 |
| 20 | 80 | 740020W | 61,00 |



DIN 40

| | | | |
|----|----|---------|-------|
| 6 | 90 | 770005W | 61,00 |
| 8 | 90 | 770007W | 61,00 |
| 10 | 90 | 770009W | 61,00 |
| 12 | 90 | 770011W | 61,00 |
| 14 | 90 | 770013W | 61,00 |
| 16 | 90 | 770015W | 61,00 |
| 18 | 90 | 770017W | 61,00 |
| 20 | 90 | 770019W | 61,00 |

EQUILIBRE 25 000 TRS/MN G2,5

• GRANDE PRÉCISION ≤0,003

EQUILIBRE 25 000 TRS/MN G2,5

• GRANDE PRÉCISION ≤0,003

MANDRIN PORTE PINCES FORT SERRAGE

PORTE-PINCES BT40

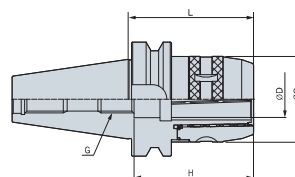

| Désignation | Référence fournisseur | Code | Prix € net HT |
|---------------|-----------------------|--------|---------------|
| BT40-NPM20-85 | 6-01-009491 | 090993 | 142,14 |
| BT40-NPM32-90 | 6-01-026590 | 090994 | 153,47 |

PORTE-PINCE SK40

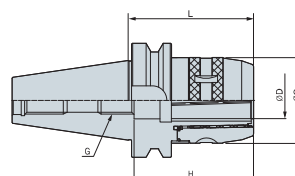

| Désignation | Référence fournisseur | Code | Prix € net HT |
|----------------|-----------------------|--------|---------------|
| SK40-NPM20-95 | 6-01-009932 | 090995 | 145,23 |
| SK40-NPM25-95 | 6-01-025587 | 090996 | 153,47 |
| SK40-NPM32-110 | 6-01-009548 | 090997 | 153,47 |
| SK40-NPM32-135 | 6-01-010709 | 090998 | 154,50 |

SET CÔNES ET PINCES



| Désignation | Référence fournisseur | Code | Prix € net HT |
|-------------------|-----------------------|--------|---------------|
| SK40-NPM32-110(A) | CPGN000072 | 090999 | 340,93 |
| BT40-NPM32-110(A) | CPGN000072 | 080997 | 340,93 |
| SK50-NPM32-110(A) | CPGN000072 | 080998 | 340,93 |
| BT50-NPM32-100(A) | CPGN000072 | 080999 | 340,93 |

MANDRIN PORTE PINCES ER32 AD + B



EQUILIBRE 15 000 TRS/MN G6,3

- GRANDE PRÉCISION $\leq 0,003$
- ARROSAGE COLLERETTE ET CENTRAL

| | L | Code | Prix € net HT | |
|--------|----|---------|---------------|-----|
| DIN 40 | 70 | 427222Z | 32,00 | (S) |
| | 70 | 840054 | 27,00 | (P) |
| BT 40 | 70 | 427221Z | 32,00 | (S) |
| | 70 | 840353 | 27,00 | (P) |

DIN 40



BT 40



(P) PAGNONI

EQUILIBRE 20 000 TRS/MN G2,5

- GRANDE PRÉCISION $\leq 0,003$
- ARROSAGE COLLERETTE ET CENTRAL

| | L | Code | Prix € net HT | |
|--------|----|---------|---------------|-----|
| DIN 40 | 70 | 427217Z | 41,00 | (S) |
| BT 40 | 70 | 427216Z | 41,00 | (S) |

DIN 40



EQUILIBRE 25 000 TRS/MN G2,5

- GRANDE PRÉCISION $\leq 0,003$
- ARROSAGE COLLERETTE ET CENTRAL

| | L | Code | Prix € net HT |
|--------|----|--------|---------------|
| DIN 40 | 70 | 770060 | 50,00 |
| BT 40 | 70 | 770065 | 50,00 |

BT 40



sk
the μ -maker
SCHÜSSLER

PORTES PINCES QUEUE CYLINDRIQUE

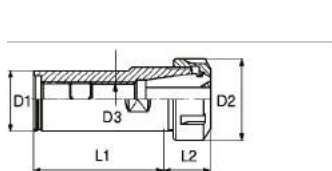

| TYPE | CAP | D1 | D2 | D3 | L1 | L2 | Code | Prix € net HT |
|------------|------|----|----|----------|----|----|---------|---------------|
| 32 NC ER32 | 2-20 | 32 | 50 | 22 x 1,5 | 80 | 33 | 427230B | 46,00 |
| 40 NC ER32 | 2-20 | 40 | 50 | 22 x 1,5 | 80 | 33 | 427231B | 46,00 |



CLE DYNAMOMETRIQUE

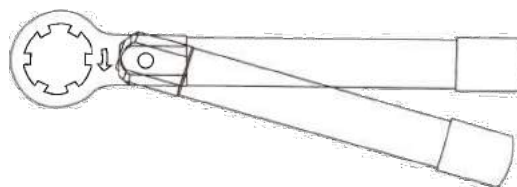

CLE DYNAMOMETRIQUE STD



| TYPE | ARTICLE | Code | Prix € net HT |
|-----------------------------|-----------|---------|------------------|
| CLE DYNAMOMETRIQUE STD ER16 | WR.DIN.16 | 427532Z | 112,00 |
| CLE DYNAMOMETRIQUE STD ER20 | WR.DIN.20 | 427533Z | 112,00 |
| CLE DYNAMOMETRIQUE STD ER25 | WR.DIN.25 | 427534Z | 124,00 |
| CLE DYNAMOMETRIQUE STD ER32 | WR.DIN.32 | 427535Z | 124,00 |
| CLE DYNAMOMETRIQUE STD ER40 | WR.DIN.40 | 427536Z | 170,00 |

CLE DYNAMOMETRIQUE MINI



| TYPE | ARTICLE | Code | Prix € net HT |
|------------------------------|----------------|---------|------------------|
| CLE DYNAMOMETRIQUE ER8 MINI | WR.DIN.8.MINI | 427537Z | 103,00 |
| CLE DYNAMOMETRIQUE ER11 MINI | WR.DIN.11.MINI | 427538Z | 103,00 |
| CLE DYNAMOMETRIQUE ER16 MINI | WR.DIN.16.MINI | 427539Z | 103,00 |
| CLE DYNAMOMETRIQUE ER20 MINI | WR.DIN.20.MINI | 427541Z | 113,00 |
| CLE DYNAMOMETRIQUE ER25 MINI | WR.DIN.25.MINI | 427542Z | 113,00 |

DEMONTE CONE ORIENTALE



| CONES | Code | Prix € net HT |
|------------------------------------|--------|------------------|
| CONE 40 HSK63A CAPTO C6 | 840800 | 99,00 |
| CONE 50 HSK100 CAPTO C10 | 840801 | 138,00 |



PRIX PROMOTIONNELS NET HT - OFFRE VALABLE DANS LA LIMITE DES STOCKS DISPONIBLES - VALIDITE 31-12-2018

TECHMO

SIEGE SOCIAL
30 rue de Montaran
45400 FLEURY LES AUBRAIS
commercial.techmo@techmo.fr
Tél. : 02 38 61 48 10
Fax : 02 38 84 39 63

TECHMO

18 chemin de la Violette
31240 L'UNION
magasin.toulouse@techmo.fr
Tél. : 05 61 61 34 35
Fax : 05 61 61 34 44

TECHMO

9 rue Laplace
33700 MERIGNAC
magasin.merignac@techmo.fr
Tél. : 05 61 61 34 35
Fax : 05 61 61 34 44

TECHMO

95 rue Normandie Niemen
64121 SERRES CASTET
magasin.pau@techmo.fr
Tél. : 05 59 90 34 10
Fax : 05 59 90 08 59

TECHMO

Parc du Chêne
12 rue du 35e Régiment d'Aviation
69500 BRON
magasin.vaulx-en-velin@techmo.fr
Tél. : 02 38 61 48 10
Fax : 05 38 84 39 63

SATECH

28, rue Alain Gerbault
ZAC du panorama
72100 LE MANS
magasin@satech.fr
Tél. : 02 43 40 05 05
Fax : 02 43 40 00 99